

CHARACTERISTICS PER MIL-S-8805

ELECTRICAL:

RATINGS @ SEA LEVEL		
TOGGLE MODE	28 VDC	115 VAC 60Hz
RESISTIVE	1 AMP	1 AMP
INDUCTIVE	.5 AMPS	.5 AMPS
PUSHBUTTON	28 VDC	115 VAC 60Hz
RESISTIVE	1 AMP	1 AMP
INDUCTIVE	.5 AMPS	.5 AMPS
DWV	1050 VRMS	

LIFE: 50,000 CYCLES (TOGGLE AND PUSHBUTTON MODES)

MECHANICAL:

TOGGLE MODE - MOMENTARY
(PUSHBUTTON MODE IS LOCKED OUT)
OPERATING FORCE: 2.5 ± .75 LBS.
RELEASE FORCE: .5 LB. MIN.
PRETRAVEL: 8° MAX.
OVERTRAVEL: 5° MIN.

PUSHBUTTON MODE - MOMENTARY
(TOGGLE MODE IS LOCKED OUT)
OPERATING FORCE: 4.5 ± .7 LBS.
RELEASE FORCE: 1 LB. MIN.
PRETRAVEL: .090 MAX.
OVERTRAVEL: .030 MIN.
TOTAL TRAVEL: .135 MAX.
LIFE: 50,000 CYCLES (TOGGLE AND PUSHBUTTON MODES)

PHYSICAL:

BUTTON: BLACK NYLON
HOUSING: BLACK ANODIZED ALUMINUM ALLOY
ENCLOSURE DESIGN: 4 (RESILIENT)
PER MIL-S-8805

MARK: OTTO CONTROLS
21649 T2-0018
TERM. IDENT.
& DATE CODE (YYWW)

POSITION	TERMINAL #	FUNCTION	MODE
1	1-2	N.O.	TOGGLE
2	1-3	N.O.	TOGGLE
3	4&5 6&7	N.O.D.B. N.O.D.B.	PUSHBUTTON

ALL POSITIONS MOMENTARY

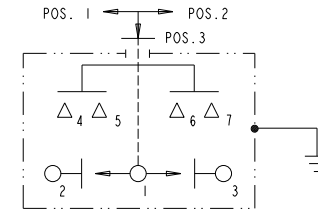
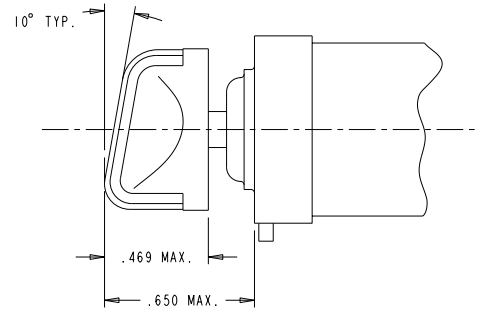

SCHEMATIC

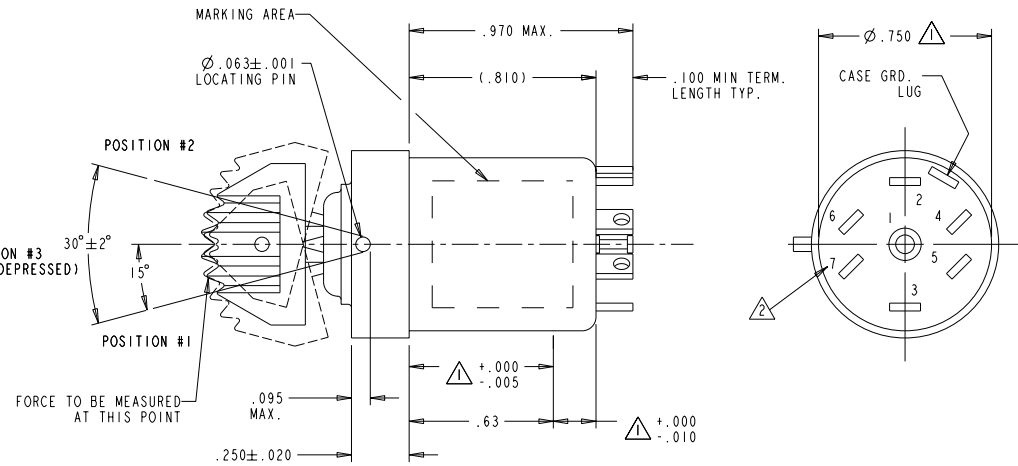
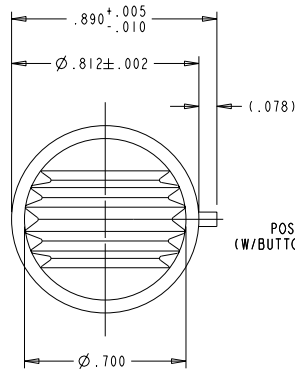

NOTES:

- 1 TOLERANCE FOR .750 FOR AREA INDICATED.
- 2 TERMINAL #'S ARE FOR REFERENCE ONLY AND DO NOT APPEAR ON THE SWITCH BOTTOM.

- MINOR
- ⊗ MAJOR
- CRITICAL
- ▲ SPC CRITICAL

UNLESS OTHERWISE SPECIFIED: DIMENSIONS ARE IN INCHES. TOLERANCES: .XX ± .03, .XXX ± .010. ANGLES ± 2°. DO NOT SCALE. THIRD ANGLE PROJECTION.

OTTO CONTROLS
DIVISION OF
OTTO ENGINEERING INC.
CARPENTERSVILLE, ILLINOIS USA

THIS DOCUMENT IS THE CONFIDENTIAL PROPERTY OF OTTO ENGINEERING, INC. IT IS PROVIDED ON A RESTRICTED BASIS AND IS NOT TO BE USED IN ANY WAY DETRIMENTAL TO THE INTERESTS OF OTTO ENGINEERING, INC.

PART NAME
SWITCH,
TOGGLE - PUSHBUTTON

DRWN. SH	SIZE	FSCM NO	DRAWING NO.	REV.
CHKD. DB	B	21649	T2-0018	D
APPD. MGC				

DATE 27 APR 92 WT. 1.25 OZ.MAX. SCALE 2:1 SHEET 1 OF 1

T2-0018
LET OCN # DATE APR
D 000946 23 APR 99 RAS