

P7-900159

LET	OCN #	DATE	APR
A	001080	11 MAY 99	GP

CHARACTERISTICS

ELECTRICAL:

LOW LEVEL 10 MILLIAMPERES AT
30 MILLIVOLTS MAX D.C. OR PEAK A.C.

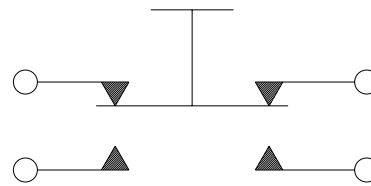

SPDT-DB
SCHEMATIC

ELECTRICAL LIFE: 50,000 CYCLES

MECHANICAL:

OPERATING FORCE: 1.7±.5 LBS.

TOTAL TRAVEL: .080 MAX.
MECHANICAL LIFE: 1,000,000 CYCLES

PHYSICAL:

ENCLOSURE DESIGN: WATERTIGHT, PER
MIL-S-8805, DESIGN 3
TEMPERATURE RANGE: -55°C TO +85°C
BUTTON: RED NYLON
CASE: BLACK ANODIZED ALUMINUM ALLOY
BODY: RYTON

MARK: OTTO, 21649
P7-900159
& DATE CODE (YYWW)

TERM. IDENT.
N.O. - ROUND ENDED
N.C. - SQUARE ENDED

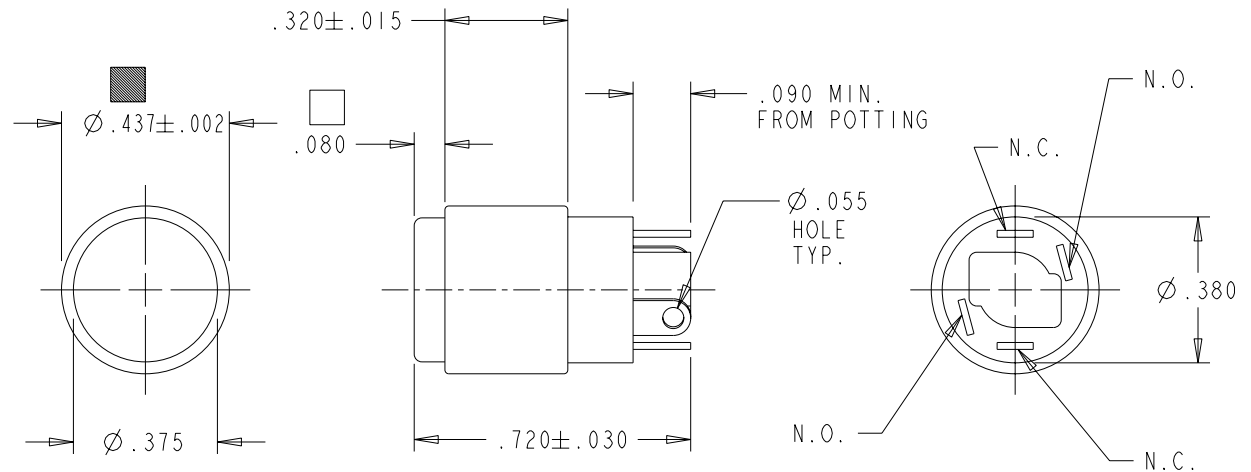

OTTO CONTROLS
DIVISION OF
OTTO ENGINEERING INC.
CARPENTERSVILLE, ILLINOIS USA

PART NAME
SWITCH,
MINI-PUSHBUTTON

MINOR MAJOR CRITICAL SPC CRITICAL

UNLESS OTHERWISE SPECIFIED:
DIMENSIONS ARE IN INCHES.
TOLERANCES ARE AS LISTED.
MUST BE FREE FROM BURRS
AND SHARP EDGES.

TOLERANCES
.XX ±.03
.XXX ±.010
ANGLES ±2°
DO NOT SCALE DRAWING.
THIRD ANGLE
PROJECTION

THIS DOCUMENT IS THE CONFIDENTIAL
PROPERTY OF OTTO ENGINEERING, INC..
IT IS PROVIDED ON A RESTRICTED
BASIS AND IS NOT TO BE USED IN ANY
WAY DETRIMENTAL TO THE INTERESTS
OF OTTO ENGINEERING, INC..

DRWN. BDS	SIZE	FSCM NO	DRAWING NO.	REV.
CHKD. GP	A	21649	P7-900159	A
APPD. ASC	DATE 11 MAY 99	WT.	SCALE 2:1	SHEET 1 OF 1